



## Key Features

Servo is ideal for lighting effects in private and residential areas. Available in two versions: mono-emission and bi-emission.

The entire product range is characterized by innovative mounting techniques and design solutions that guarantee very low temperatures on the external surface of the luminaire.

Ground recessed round LED luminaire for installation outdoor for walk over and drive over with high mechanical strength.

Designed to last in extremely harsh environments.



## Key Data

<b>LED Type</b>	High efficiency LEDs, available in 2700K, 3000K, 4000K, 5000K, 6500K CCT tolerance within a 3-step MacAdams ellipse and LM80 compliant. Custom LED color combinations available.
<b>Nominal Voltage</b>	220V-240V AC, 50/60Hz
<b>Color Rendering Index</b>	CRI ≥ 80 standard and CRI ≥ 90 on request.
<b>Optics</b>	180° (Two Sided)
<b>Materials</b>	Corrosion resistant double layer polyester powder coated paint finish die cast aluminium housing with stainless steel screws (A4 grade) and silicone gaskets. Power unit is built in. Available in anthracite gray as a standard finish or any desired RAL colour. Includes recessing box.
<b>Diffuser</b>	High impact and heat resistant polycarbonate with UV protection.
<b>LED Life Time</b>	L90 - B10 > 100,000h
<b>Operating Temperature</b>	-40°C / +55°C
<b>Power Factor</b>	>0.95
<b>Control Systems</b>	On - Off.
<b>Protection Class</b>	IP67
<b>Impact Resistance</b>	IK10
<b>Load Rating</b>	40 kN
<b>Insulation Class</b>	Class I
<b>Installation</b>	Recessing box to be placed at ground level 20 cm drainage gravel for water evacuation. Connection via junction boxes.
<b>Conformity</b>	Complies with European Standards EN 60598 and CE certified.

### Technical Drawing

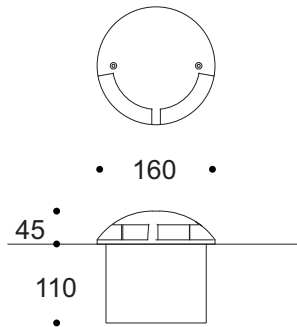

### Information

CODE	POWER CONSUMPTION	LUMEN OUTPUT (lm) 3000K / 4000K	COLOUR TEMPERATURE
AC8038	6W	450 / 510	3000K / 4000K

### Light Distribution Curve

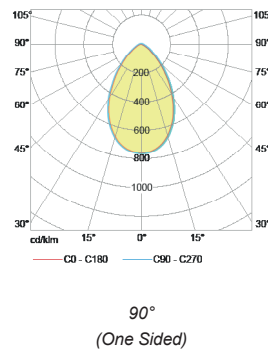

### Accessories



**IP68 Plug Power  
Connector Set**  
Code: CON1201