

Key Features

Servo is ideal for lighting effects in private and residential areas. Available in two versions: mono-emission and bi-emission.

The entire product range is characterized by innovative mounting techniques and design solutions that guarantee very low temperatures on the external surface of the luminaire.

Ground recessed round LED luminaire for installation outdoor for walk over and drive over with high mechanical strength.

Designed to last in extremely harsh environments.



Key Data

LED Type	High efficiency LEDs, available in 2700K, 3000K, 4000K, 5000K, 6500K CCT tolerance within a 3-step MacAdams ellipse and LM80 compliant. Custom LED color combinations available.
Nominal Voltage	220V-240V AC, 50/60Hz
Color Rendering Index	CRI ≥ 80 standard and CRI ≥ 90 on request.
Optics	180° (Two Sided)
Materials	Corrosion resistant double layer polyester powder coated paint finish die cast aluminium housing with stainless steel screws (A4 grade) and silicone gaskets. Power unit is built in. Available in anthracite gray as a standard finish or any desired RAL colour. Includes recessing box.
Diffuser	High impact and heat resistant polycarbonate with UV protection.
LED Life Time	L90 - B10 > 100,000h
Operating Temperature	-40°C / +55°C
Power Factor	>0.95
Control Systems	On - Off.
Protection Class	IP67
Impact Resistance	IK10
Load Rating	40 kN
Insulation Class	Class I
Installation	Recessing box to be placed at ground level 20 cm drainage gravel for water evacuation. Connection via junction boxes.
Conformity	Complies with European Standards EN 60598 and CE certified.

Technical Drawing

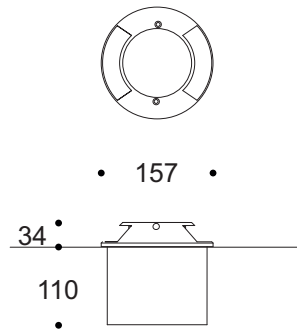

Information

CODE	POWER CONSUMPTION	LUMEN OUTPUT (lm) 3000K / 4000K	COLOUR TEMPERATURE
AC8034	6W	450 / 510	3000K / 4000K

Light Distribution Curve

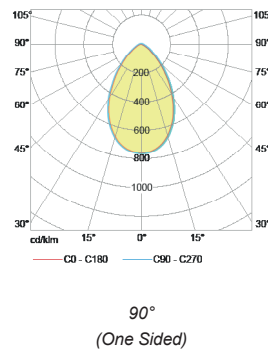

Accessories



**IP68 Plug Power
Connector Set**
Code: CON1201