



PRODUCT FEATURES:

Compact LED floodlight range ideal to highlight and emphasize architectural details or plants and also perfect to illuminate walls, facades and monumental structures.
iTubo FL provides a high-intensity wash of light with customisable beam angles for architectural floodlighting.
The head is adjustable, making it easy to focus incident light on the exposed element.
Advanced thermal design with cutting-edge manufacturing process and materials.
Designed to last in extremely harsh environments.

RECOMMENDATIONS FOR THE USER:

- 1) Before the installation, make sure that there is no voltage.
- 2) Do not touch the fitting when it is working on / switched on
- 3) Do not look at the fitting directly or from a short distance.
- 4) Disconnect / switch off the fitting before changing the lamps

NOTES:

- Technical amendments are reserved.
- CE – Conformity mark
- The manufacturer is then discharged from liability when damage is caused by improper use or installation.
- Clean luminaire regularly with solvent-free cleansers from dirt and deposits. Do not use high pressure cleaners.

Follow the steps below for assembly:

1) Rigid Floor Mounting;

- Holes are drilled into the ground and the fixing plugs are fastened.
- The luminaire is screwed to the ground.
- The screws on the mounting foot can be loosened and brought to the desired angle and the screw can be tightened again.

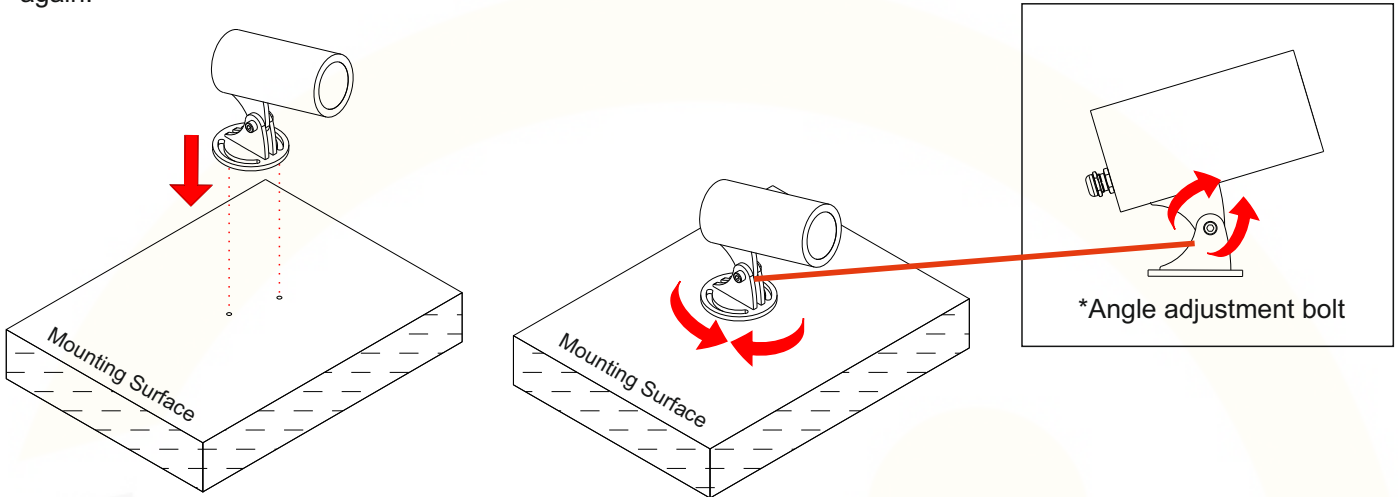

2) Ground Mounting;

- The luminaire is screwed to the spike and mounted to the ground.

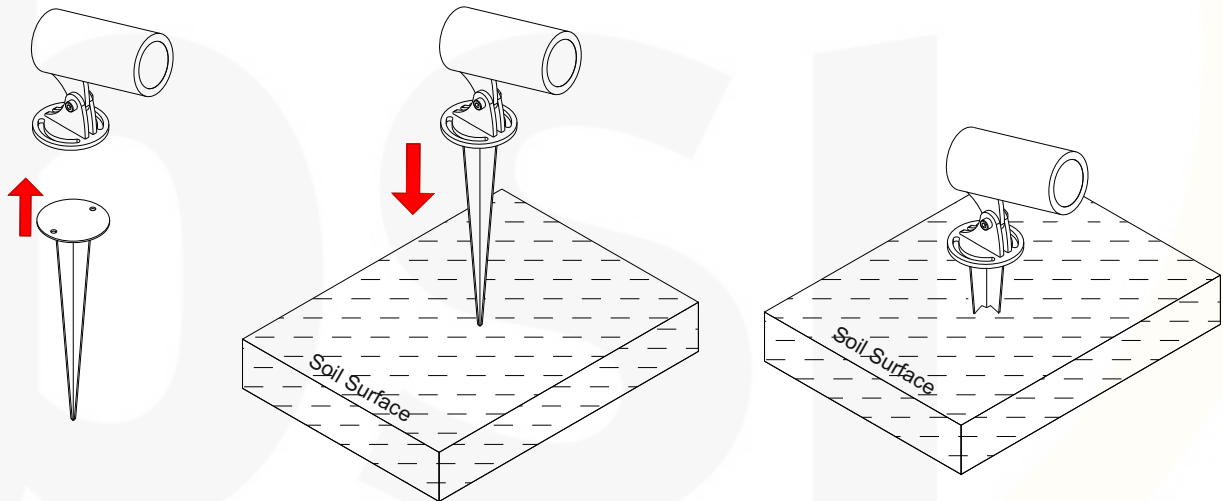

3) Electrical Connection

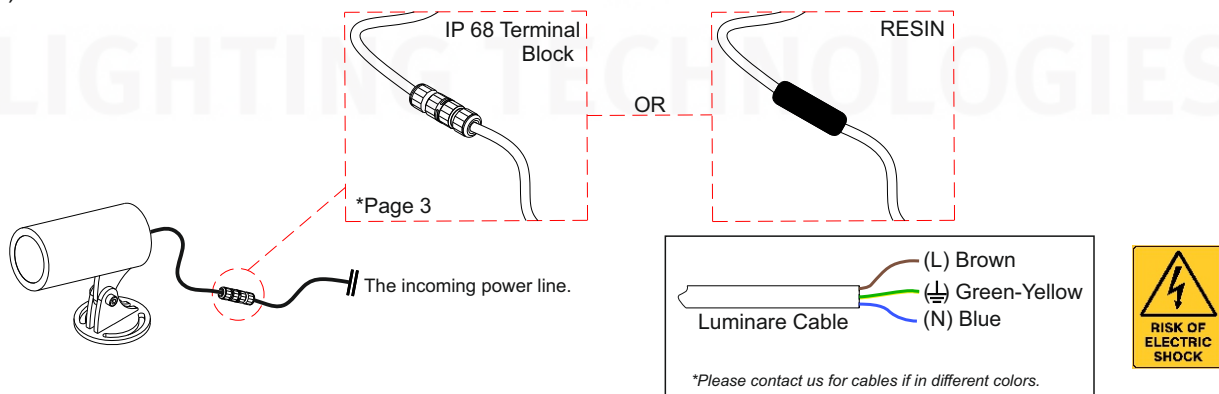

TH9
2-3-4 POLES

1

2

Screw terminals

2-3-4 POLES

①	←	①
②	←	②
③	←	③
⊕	←	④

2.1
Piercing terminals version

No unsheathing

3

4

CONSIDERATIONS:

- Do not cut-off or damage the cables of the products supplied as sockets. Otherwise, water may enter to the luminaire through cable and damage the electronic parts inside.
- If you make the electrical connection, except for IP.68 Terminal Block; the connections must be under IP protection. Otherwise, water may enter to the luminaire through cable and damage the electronic parts inside.
- The IP68 Connecting kits must be assembled in accordance with the installation instructions. Otherwise, water may enter to the luminaire through cable and damage the electronic parts inside.
- The luminaire should not be opened and screws should not be loosened. If you want to open the luminaire, please contact our company.

OUT OF WARRANTY SITUATIONS:

- Opening the product or loosening the screws.
- Product last output cable is not protected IP67-IP68.
- Faulty electrical connection.
- Wrong IP68 socket-terminal block- plug connector connection.
(Wrong opening of the cable length, faulty tightening the screws etc.)
- If the IP68 Connecting kits are under water.