



PRODUCT FEATURES:

iAxis Recessed Ceiling luminaire is suitable for outdoor soffits and undercanopy installations. It is a fully gasketed architectural luminaire for continuous runs and perfect complement for outdoor spaces to ensure design consistency.

Architectural ceiling lighting range inspires architects, designers and system integrators with its exceptional quality, precise optical systems and remarkable creativity.

Designed to last in extremely harsh environments.

RECOMMENDATIONS FOR THE USER:

- 1) Before the installation, make sure that there is no voltage.
- 2) Do not touch the fitting when it is working on / switched on
- 3) Do not look at the fitting directly or from a short distance.
- 4) Disconnect / switch off the fitting before changing the lamps
- 5) The safety of this fixture is guaranteed only if you comply with these instructions.

NOTES:

- Technical amendments are reserved.
- CE – Conformity mark
- The manufacturer is then discharged from liability when damage is caused by improper use or installation.
- Clean luminaire regularly with solvent-free cleansers from dirt and deposits. Do not use high pressure cleaners.
- Cleaning agents containing hydrochloric acid and chlorides should never be used.

1) iAxis Recessed Ceiling Spring Type Mounting is as follows:

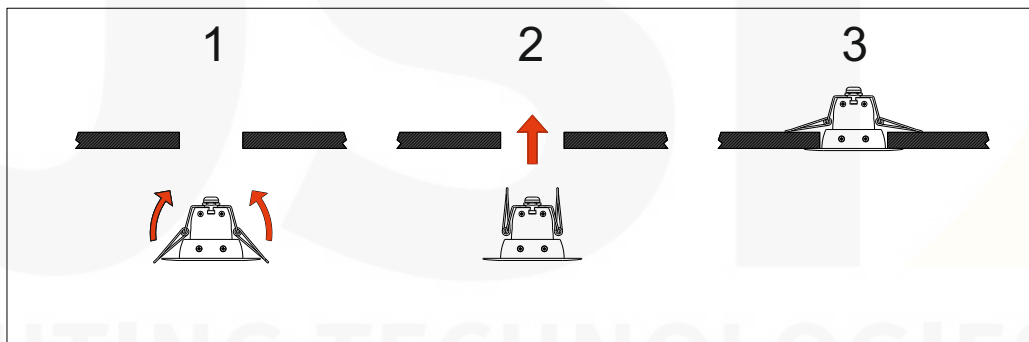
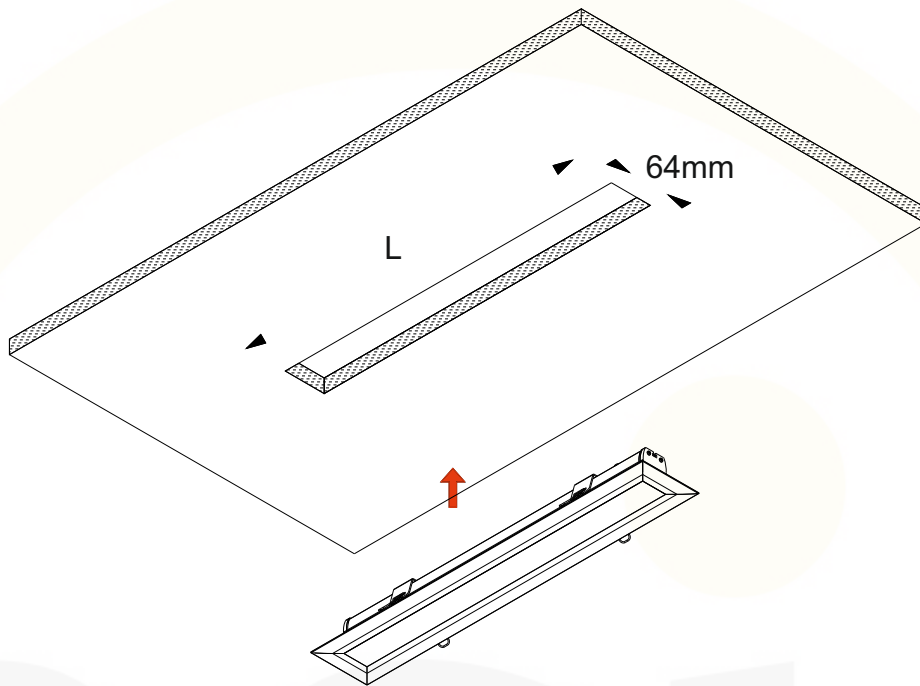

TH9
2-3-4 POLES

1

ADAPTER HOLE
Ø 9.0 mm

2

Screw terminals

2-3-4 POLES

①	←	①
②	←	②
③	←	③
⊕ ④	←	④

2.1
Piercing terminals version

20mm

No unsheathing

3

4

Warning:

- Do not cut-off or damage the cables of the products supplied as sockets. Otherwise, water may enter to the luminaire through cable and damage the electronic parts inside.
- If you make the electrical connecton, except for IP.68 Terminal Block - IP.68 Plug connector - IP.68 socket; the connectons must be under IP protecton. Otherwise, water may enter to the luminaire through cable and damage the electronic parts inside.
- The IP68 Connecting kits must be assembled in accordance with the installaton instructions. Otherwise, water may enter to the luminaire through cable and damage the electronic parts inside.
- Mounting hole should be drainaged.

Out of Warranty Stuations:

Product last output cable is not protected IP67-IP68.

Faulty electrical connecton.

Wrong IP68 socket-terminal block- plug connector connecton.
(Wrong opening of the cable length, fauly tightening the screws etc.)

If the IP68 Connecting kits are under water.

No drainage in the mounting hole.