



PRODUCT FEATURES:

iAxis String is a durable and virtually maintenance surface mounted modular curved luminaire suitable for a wide range of cove, wall washing, accent, surface grazing, and indirect lighting applications in architectural, hospitality and retail environments.

Designed to last in extremely harsh environments.

Monochrome or DALI controllable, easy to install with the remote power supply and connect via combined power and data connectors.

RECOMMENDATIONS FOR THE USER:

- 1) Before the installation, make sure that there is no voltage.
- 2) Do not touch the fitting when it is working on / switched on
- 3) Do not look at the fitting directly or from a short distance.
- 4) Disconnect / switch off the fitting before changing the lamps

NOTES:

- Technical amendments are reserved.
- CE – Conformity mark
- The manufacturer is then discharged from liability when damage is caused by improper use or installation.
- Clean luminaire regularly with solvent-free cleansers from dirt and deposits. Do not use high pressure cleaners.

- 1) - Drill holes on the mounting surface and hammer the bolts to be equal to the mounting holes on the mounting part.
 - The mounting part is screwed onto the mounting floor.

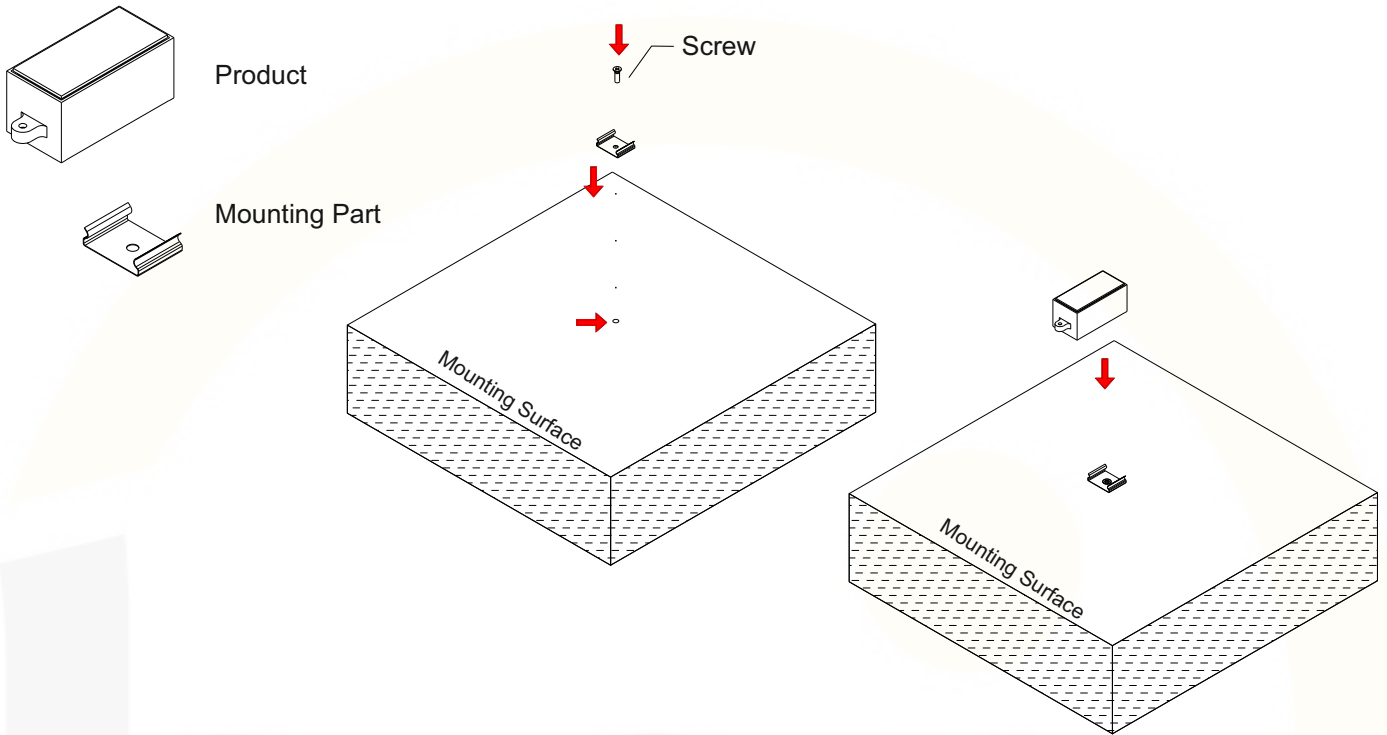

2) Adding products consecutively;

- Products are added one after the other and tightened together with screws and fiber nuts.

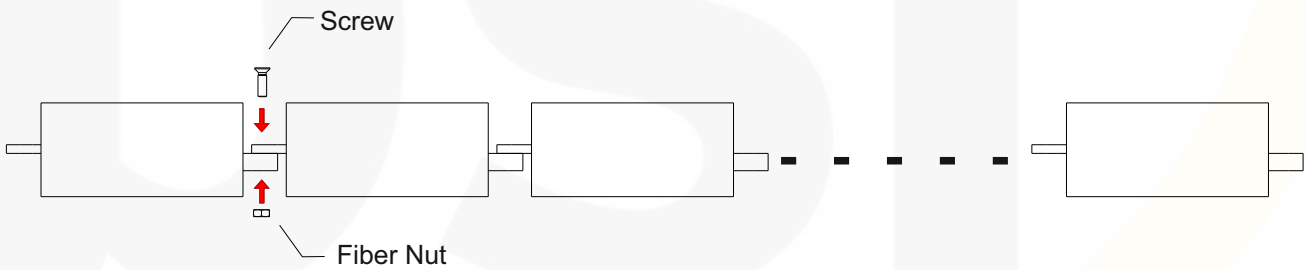

- The product can be angled up to 45 degrees.

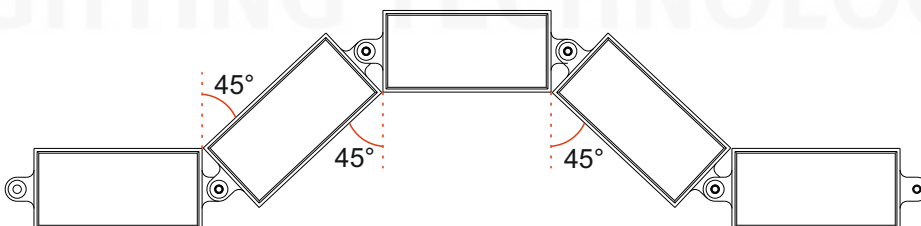

3) Connection detail;

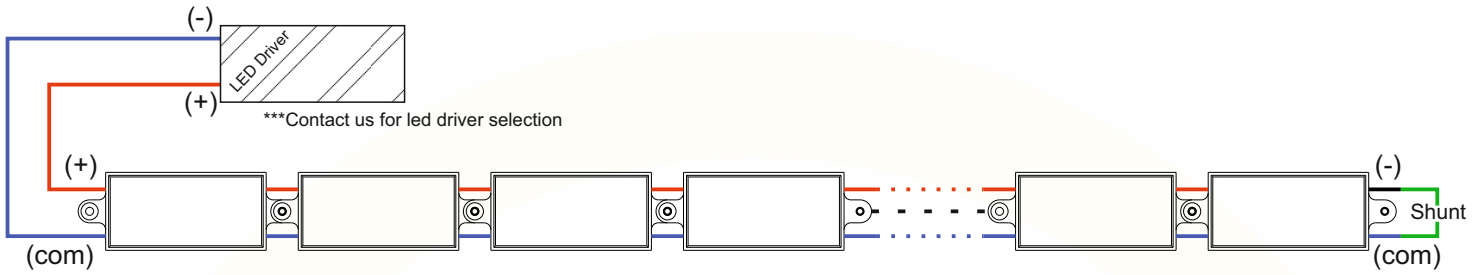

	VDC	350mA	500mA	700mA
Ar91593 1 Module(70mm)	6Vdc	2W	3W	4W
Ar91594 1 Module(120mm)	12Vdc	4W	6W	8W

	VDC	350mA	500mA	700mA
Ar91593 12 Modules(1mt)	~ 72Vdc	24W	36W	48W
Ar91594 6 Modules(0.8mt)	~ 72Vdc	24W	36W	48W

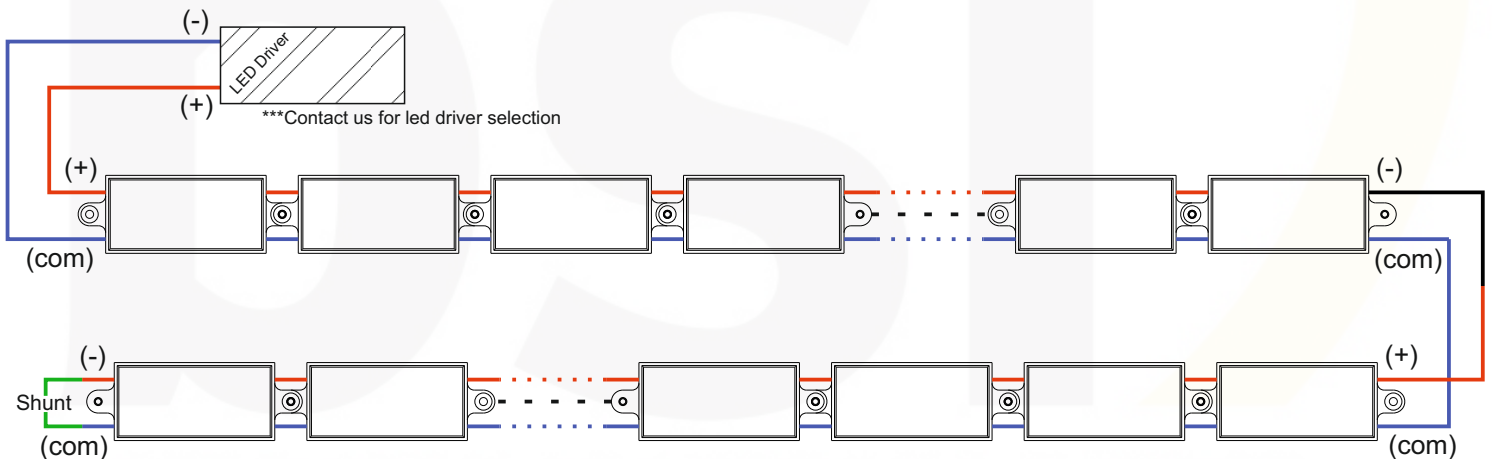

****WE REMOMMED MAX:	VDC	350mA	500mA	700mA
Ar91593 24 Modules(2mt)	~ 144Vdc	48W	72W	96W
Ar91594 12 Modules(1.6mt)	~ 144Vdc	48W	72W	96W

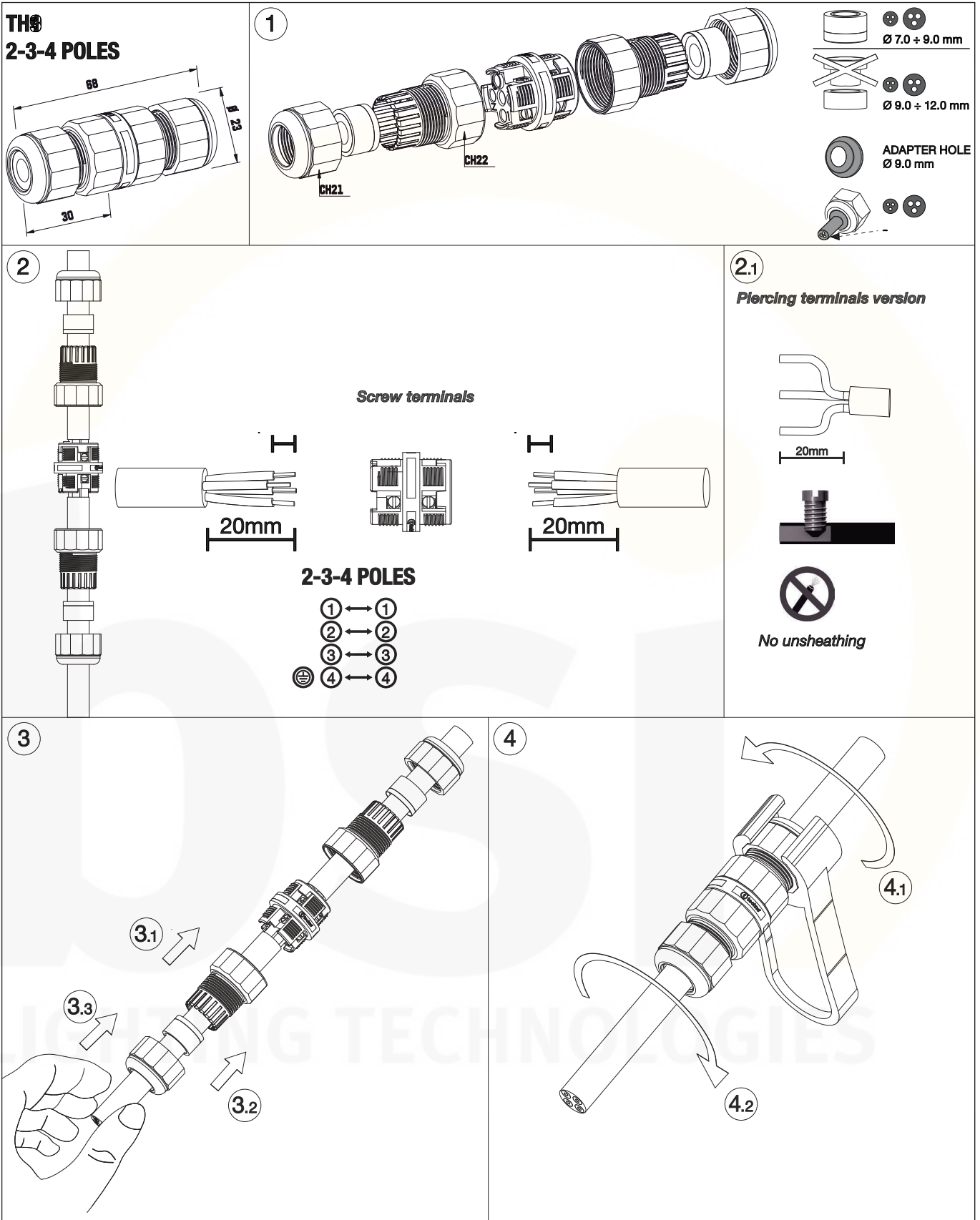

TH387
2-3-4-5 POLES

①

Ø 7.0 ± 8.5 mm

Ø 9.0 ± 13.5 mm

ADAPTER HOLE
Ø 9.0 mm

≤ Ø 6.0 ± 7.0 mm

②

Screw terminals

6mm
25mm

6mm
25mm

4 POLES

①	←	①
②	←	②
③	←	③
④	←	④
⑤	←	⑤

②.1

Piercing terminals version

25mm

No unsheathing

③

3.1, 3.2, 3.3

④

4.1, 4.2

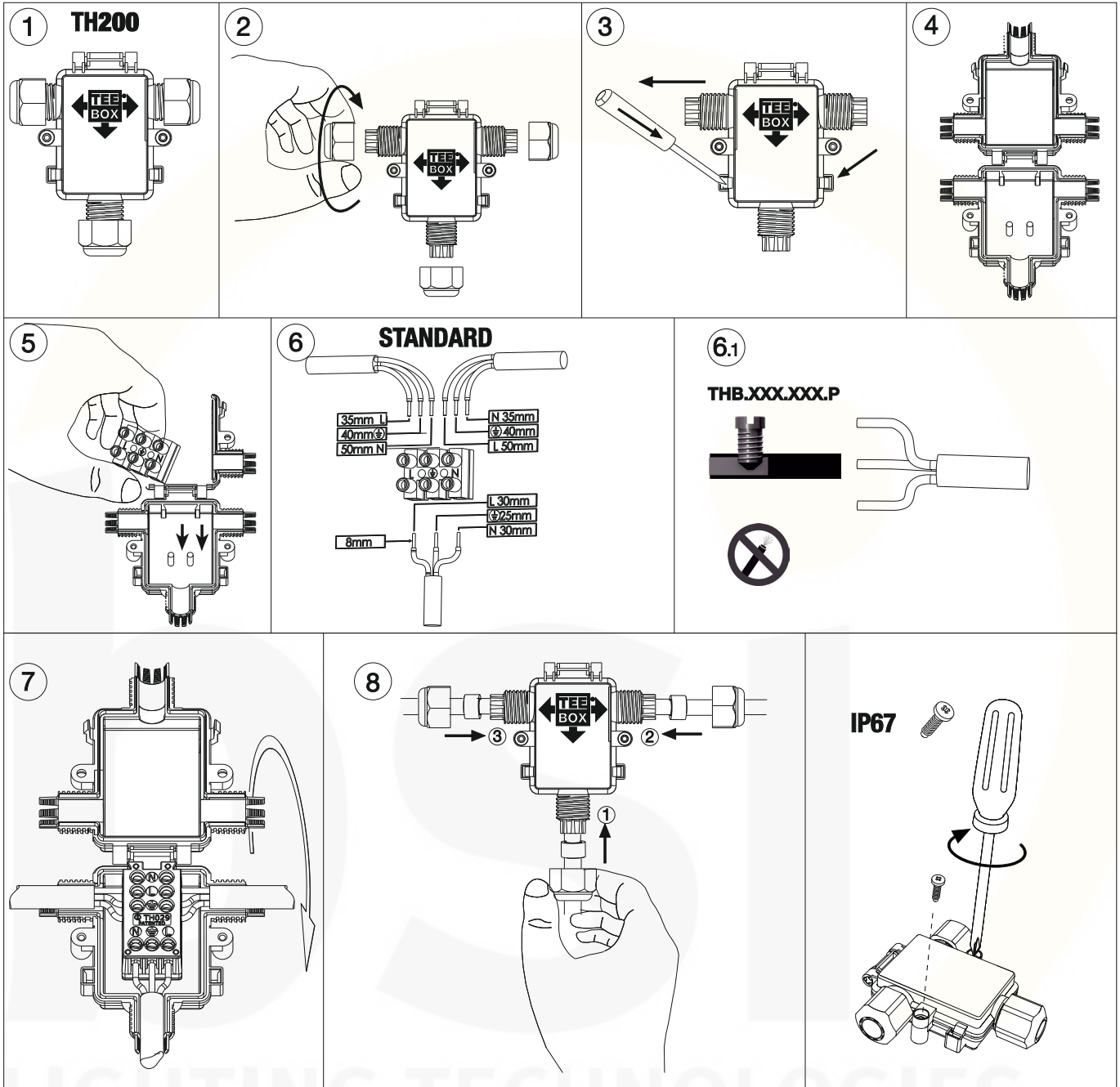

Considerations

- Do not cut-off or damage the cables of the products supplied as sockets. Otherwise, water may enter to the luminaire through cable and damage the electronic parts inside.
- If you make the electrical connection, except for IP.68 Terminal Block - IP.68 Plug connector - IP.68 socket; the connections must be under IP protection. Otherwise, water may enter to the luminaire through cable and damage the electronic parts inside.
- The IP68 Connecting kits must be assembled in accordance with the installation instructions. Otherwise, water may enter to the luminaire through cable and damage the electronic parts inside.
- The luminaire should not be opened and screws should not be loosened. If you want to open the luminaire, please contact our company.

Out of Warranty Situations

- Opening the product or loosening the screws.
- Product last output cable is not protected IP67-IP68.
- Faulty electrical connection.
- Wrong IP68 socket-terminal block- plug connector connection.
(Wrong opening of the cable length, faulty tightening the screws etc.)
- If the IP68 Connecting kits are under water.

bsi
LIGHTING TECHNOLOGIES